

Rittal – The System.

Faster – better – everywhere.



ORV2 Busbar Spec Update Proposal



ORV2 Busbar Spec Update Proposal

- **Problem**

- Highlight design constraints with power shelf and busbar connection (outside of 3OU shelves).

- **Suggestion**

- Rittal's proposal to alleviate the constraints.

- **Solution**

- Openly discuss ORV2 specification update.

Problem

Section 2.5 is written around the use of a 3OU power shelf. Other configurations using 1OU power shelves require the power leads to have a dog leg design taking up space.

Review of Current ORV2.1 Specification

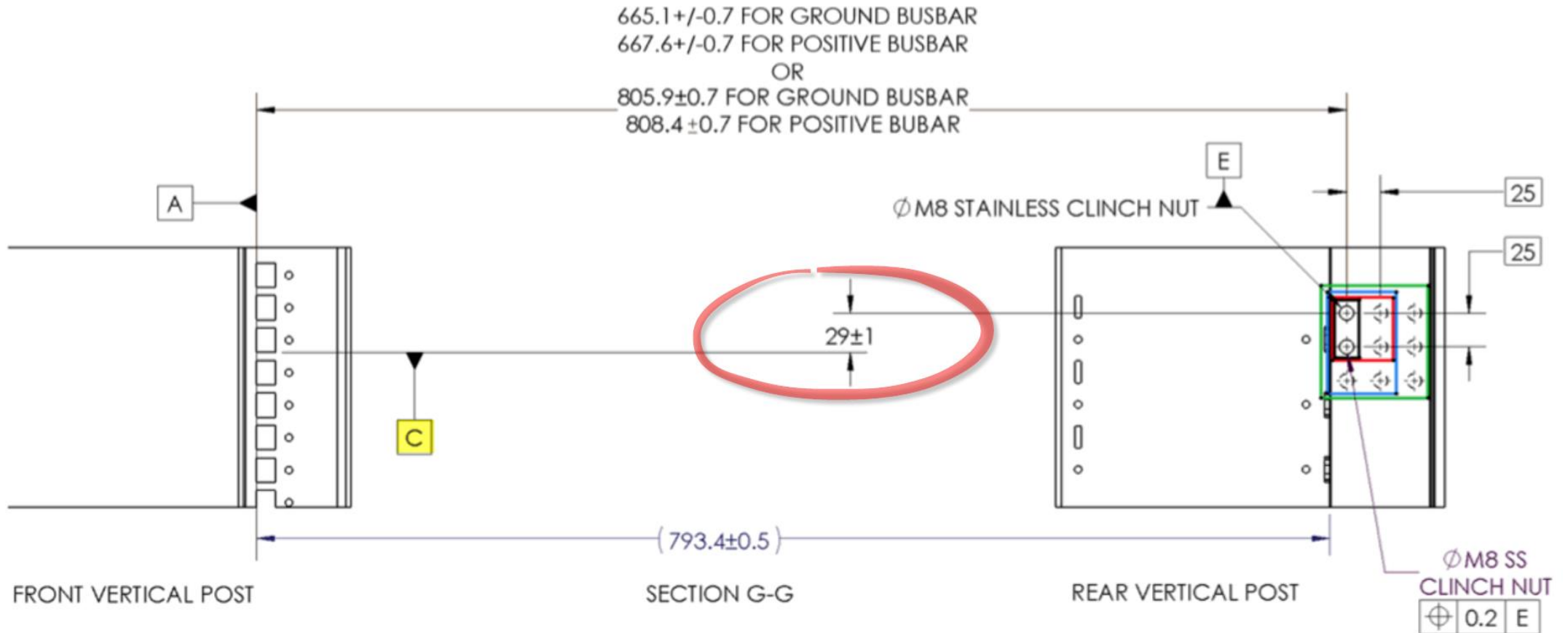

Misalignment Example

10U power shelf shown

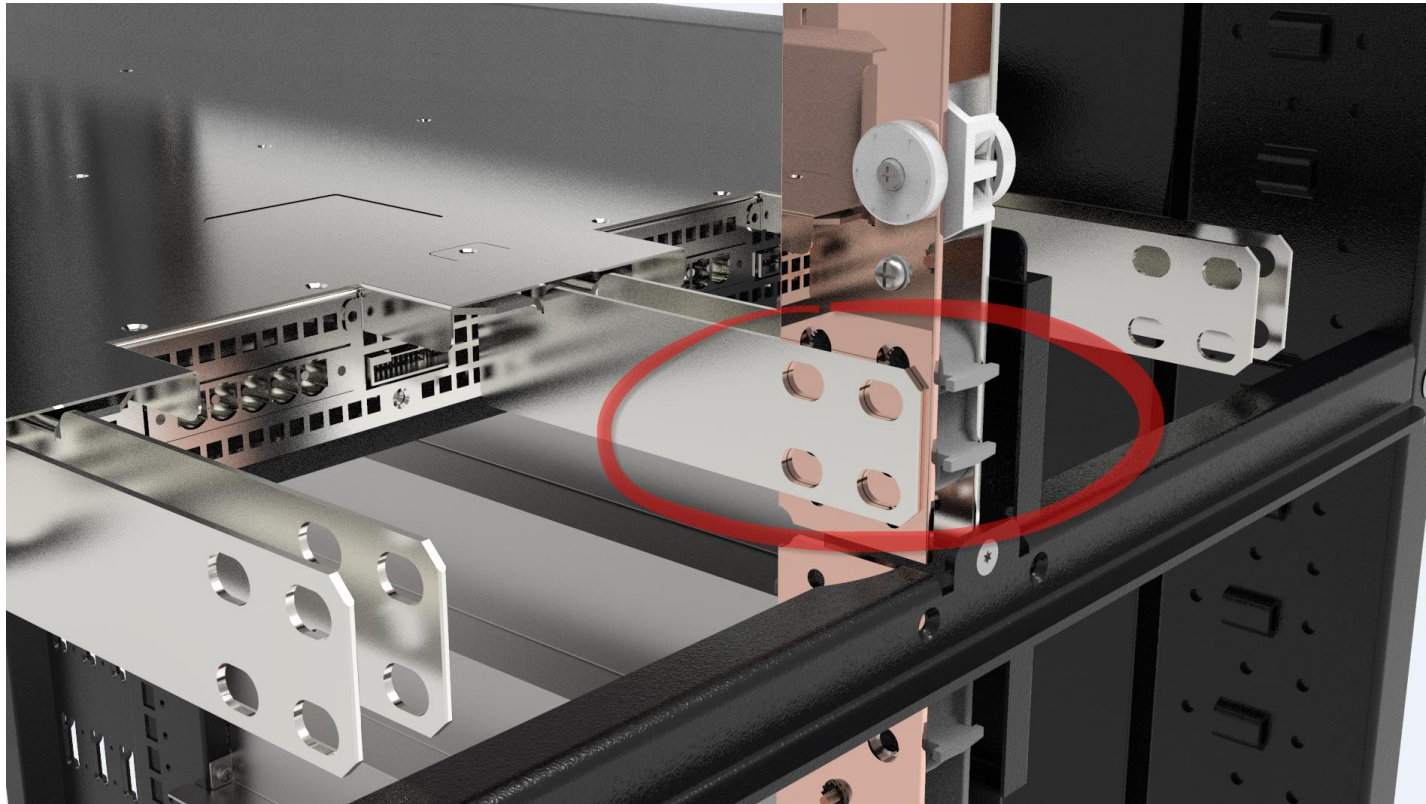

Suggestion

Update section 2.5.1.2 by adding additional bolt patterns options.

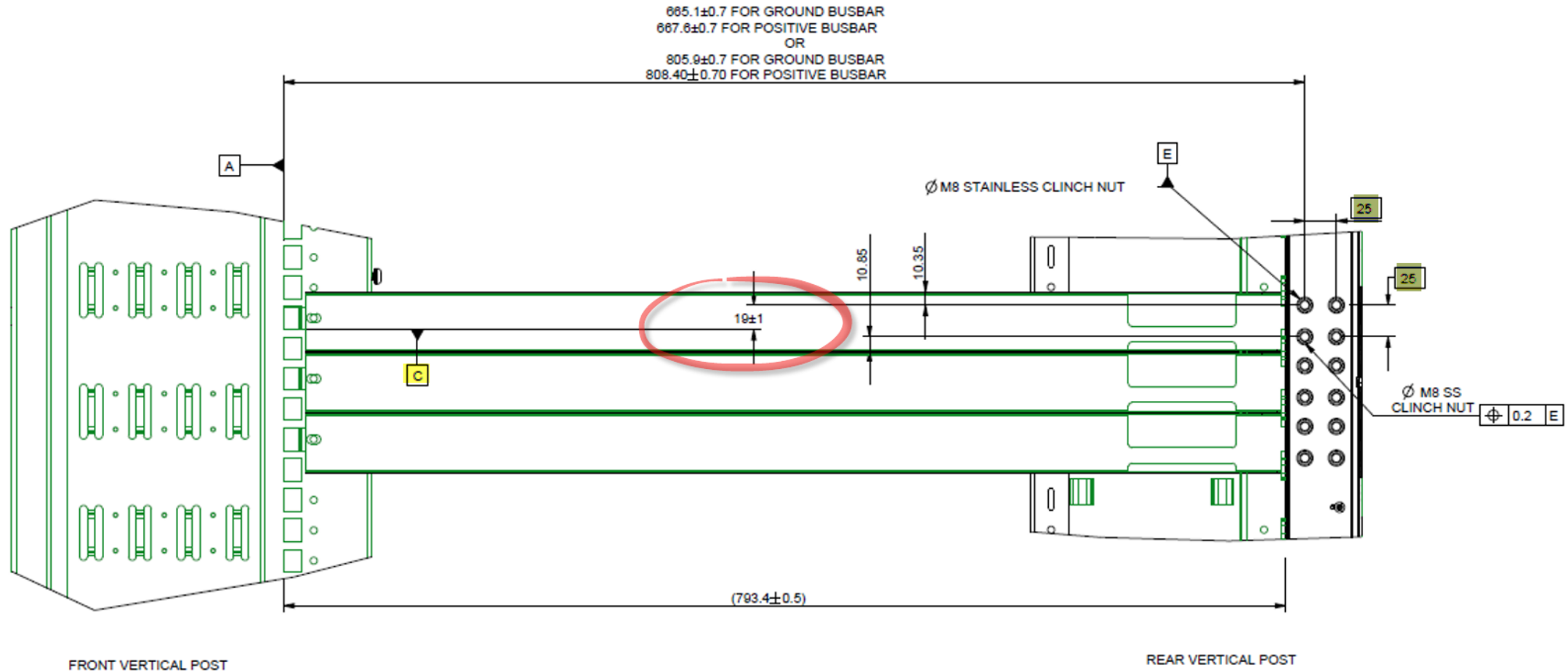

Discussion Recap

- **Problem**

- Section 2.5 is written around the use of a 3OU power shelf. Other configurations using 1OU power shelves require the power leads to have a dog leg design taking up space.

- **Suggestion**

- Update section 2.5.1.2 with optional bolt patterns.

- **Solution**

- Add additional bolt patterns like a 25 x 25 pattern at 19 +/-1 from datum C in addition to the current 29 +/-1.

Thank you.

ENCLOSURES

POWER DISTRIBUTION

CLIMATE CONTROL

IT INFRASTRUCTURE

SOFTWARE & SERVICES

