

# OPEN POSSIBILITIES.

## OCP Ready Guidelines for Deploying Modular Data Centers



**OCP**  
GLOBAL  
SUMMIT

NOVEMBER 9-10, 2021

# OCP Ready Guidelines for Deploying Modular Data Centers

Karl Rabe, Colocation.Green

Rob Coyle, OCP Ready Project Co-Lead

OPEN POSSIBILITIES.



**OPEN**  
COMMUNITY®



# Panel Introduction

## Karl Rabe

- Mechatronic Engineer
- Sustainable DC Pioneer ( Windcloud Br. / Windcloud 4.0 )
- SDN Cloud & HPC Architect

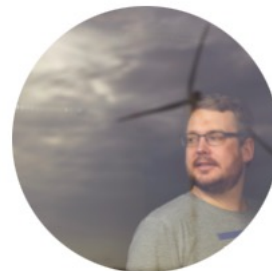

**DATA CENTER  
FACILITIES**

## Rob Coyle

- Construction Heritage
- Technology Addict
- Infrastructure Problem Seeker



OPEN POSSIBILITIES.



# Problem Statement



DATA CENTER  
FACILITIES

- There is a lack of consistency around modular data center site requirements.
- Specific requirements for deploying OCP hardware in a modular environment needs to be considered to improve adoption rates and leverage advantages of OCP Hardware.

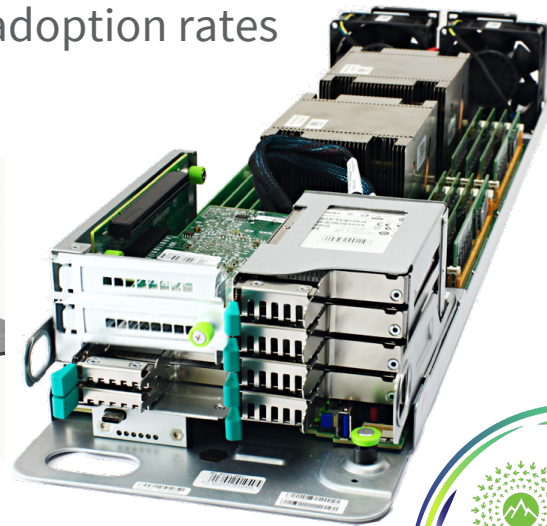
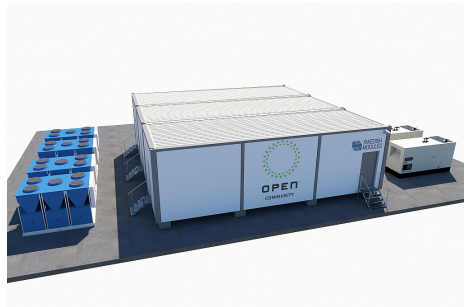
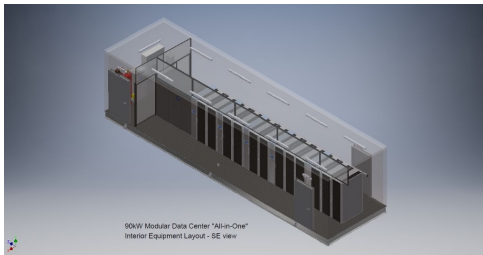

OPEN POSSIBILITIES.



# Potential Resource



**Step 1** · Confirm your facility meets the OCP [Colo Facility Guidelines for OCP Racks](#).

**Step 2** · Must complete the OCP Ready™ Colo Site Assessment ([Excel Version](#)), ([Google Sheet Version](#)) (please reach out to Foundation Staff or OCP Project Leads for assistance with the Assessment)

If approved, your facility will receive OCP Ready recognition and logos, and will be listed on the OCP Marketplace (if contributor is an OCP Colo Solution Provider).

OPEN POSSIBILITIES.



# Proposed Solution

- DCF-MDC Workstream - OCP Ready MDC
- Guidelines to level set site requirements for modular data centers
- Model after existing OCP Ready requirements



DATA CENTER  
FACILITIES



OPEN POSSIBILITIES.



# OCP Ready Guidelines

- Guideline document status
- Example challenge adopting existing OCP Ready Guidelines
- Checklist status
- What criteria are most critical in a modular data center compared to a colocation facility



DATA CENTER  
FACILITIES

OPEN POSSIBILITIES.



# Product/Facility Info



Colocation Facility Guidelines  
for Deployment of  
Open Racks

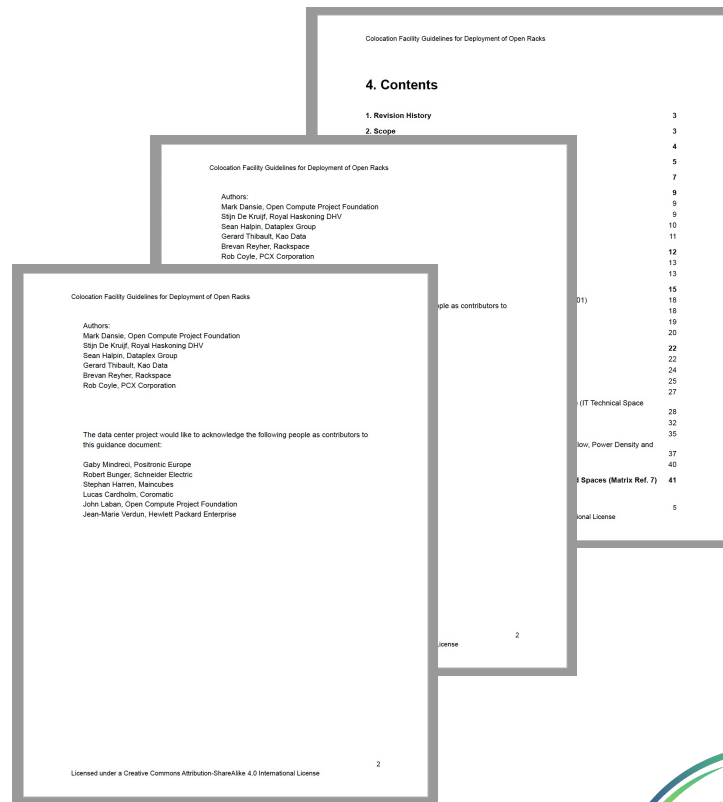

OPEN POSSIBILITIES.





# Product/Facility Info



| OCF Ready COLD Facility Assessment                                       | [Site #1 specific name] |        |       | [Site #2 specific name] |        |       | [Site #3 specific name] |        |       |
|--|-------------------------|--------|-------|-------------------------|--------|-------|-------------------------|--------|-------|
| Self Assessment Status   | NOT COMPLETED           |        |       | NOT COMPLETED           |        |       | NOT COMPLETED           |        |       |
| Site Center Location Name  |                         |        |       |                         |        |       |                         |        |       |
| Site Description: White Space Area                                       |                         |        |       |                         |        |       |                         |        |       |
| Site Description: Critical IT Power                                      |                         |        |       |                         |        |       |                         |        |       |
| Site Description: Network Provider Availability                          |                         |        |       |                         |        |       |                         |        |       |
| Site Description: Facility Features                                      |                         |        |       |                         |        |       |                         |        |       |
| Site Description: Other Services   |                         |        |       |                         |        |       |                         |        |       |
| Date Original Assessment is Completed                                    |                         |        |       |                         |        |       |                         |        |       |
| Date Assessment Date   |                         |        |       |                         |        |       |                         |        |       |
| REQUIREMENTS - Attributes<br>(Must have an Optimum or Acceptable result) | Parameter               | Result | Notes | Parameter               | Result | Notes | Parameter               | Result | Notes |
| <b>ACCESS</b>  |                         |        |       |                         |        |       |                         |        |       |
| Building Access  | 0. Selection Required   |        |       | 0. Selection Required   |        |       | 0. Selection Required   |        |       |
| Delivery pathway, loading dock to Grade 1                                | 0. Selection Required   |        |       | 0. Selection Required   |        |       | 0. Selection Required   |        |       |
| Delivery pathway, Grade 1 to White space                                 | 0. Selection Required   |        |       | 0. Selection Required   |        |       | 0. Selection Required   |        |       |
| Corridor floor rolling load  | 0. Selection Required   |        |       | 0. Selection Required   |        |       | 0. Selection Required   |        |       |
| Unloading/loading/staging area floor uniform load                        | 0. Selection Required   |        |       | 0. Selection Required   |        |       | 0. Selection Required   |        |       |
| Unloading/loading/staging area floor concentrated load                   | 0. Selection Required   |        |       | 0. Selection Required   |        |       | 0. Selection Required   |        |       |
| <b>BASES</b>   |                         |        |       |                         |        |       |                         |        |       |
| Gradient   | 0. Selection Required   |        |       | 0. Selection Required   |        |       | 0. Selection Required   |        |       |
| Width  | 0. Selection Required   |        |       | 0. Selection Required   |        |       | 0. Selection Required   |        |       |
| Landing area   | 0. Selection Required   |        |       | 0. Selection Required   |        |       | 0. Selection Required   |        |       |
| Railings   | 0. Selection Required   |        |       | 0. Selection Required   |        |       | 0. Selection Required   |        |       |
| <b>LIFTS / ELEVATORS</b>   |                         |        |       |                         |        |       |                         |        |       |
| Weight loading   | 0. Selection Required   |        |       | 0. Selection Required   |        |       | 0. Selection Required   |        |       |
| Door height  | 0. Selection Required   |        |       | 0. Selection Required   |        |       | 0. Selection Required   |        |       |
| Stairs   | 0. Selection Required   |        |       | 0. Selection Required   |        |       | 0. Selection Required   |        |       |
| Drum   | 0. Selection Required   |        |       | 0. Selection Required   |        |       | 0. Selection Required   |        |       |
| <b>WHITE SPACE</b>   |                         |        |       |                         |        |       |                         |        |       |
| Floor rolling load   | 0. Selection Required   |        |       | 0. Selection Required   |        |       | 0. Selection Required   |        |       |
| Floor uniform load   | 0. Selection Required   |        |       | 0. Selection Required   |        |       | 0. Selection Required   |        |       |
| Floor concentrated load  | 0. Selection Required   |        |       | 0. Selection Required   |        |       | 0. Selection Required   |        |       |
| Finished floor to ceiling height   | 0. Selection Required   |        |       | 0. Selection Required   |        |       | 0. Selection Required   |        |       |
| Access floor clearance   | 0. Selection Required   |        |       | 0. Selection Required   |        |       | 0. Selection Required   |        |       |
| <b>ELECTRICAL</b>  |                         |        |       |                         |        |       |                         |        |       |
| Number of independent circuits to the rack                               | 0. Selection Required   |        |       | 0. Selection Required   |        |       | 0. Selection Required   |        |       |
| Maximum circuit capacity   | 0. Selection Required   |        |       | 0. Selection Required   |        |       | 0. Selection Required   |        |       |
| Circuit voltage  | 0. Selection Required   |        |       | 0. Selection Required   |        |       | 0. Selection Required   |        |       |
| Circuit frequency  | 0. Selection Required   |        |       | 0. Selection Required   |        |       | 0. Selection Required   |        |       |
| Power receptacle NEMA Type   | 0. Selection Required   |        |       | 0. Selection Required   |        |       | 0. Selection Required   |        |       |
| Circuit receptacle location  | 0. Selection Required   |        |       | 0. Selection Required   |        |       | 0. Selection Required   |        |       |
| Upstream UPS options   | 0. Selection Required   |        |       | 0. Selection Required   |        |       | 0. Selection Required   |        |       |
| Rack based batteries permitted   | 0. Selection Required   |        |       | 0. Selection Required   |        |       | 0. Selection Required   |        |       |
| Generator load acceptance time   | 0. Selection Required   |        |       | 0. Selection Required   |        |       | 0. Selection Required   |        |       |
| <b>COOLING</b>   |                         |        |       |                         |        |       |                         |        |       |
| Rack airflow direction   | 0. Selection Required   |        |       | 0. Selection Required   |        |       | 0. Selection Required   |        |       |

OPEN POSSIBILITIES.

# Call to Action

- How to get involved in the Project/Sub-Project Community
- Timeline for Contribution Availability
  - OCP MDC Checklist – 1<sup>st</sup> Draft November 2021
  - OCP MDC Guidelines – 1<sup>st</sup> Draft January 2022

Project Wiki with latest specification : [https://www.opencompute.org/wiki/Data\\_Center\\_Facility/OCP\\_Ready](https://www.opencompute.org/wiki/Data_Center_Facility/OCP_Ready)

Mailing list: <https://ocp-all.groups.io/g/OCP-MDC>

OPEN POSSIBILITIES.



# Open Discussion



NOVEMBER 9-10, 2021